

Interchangeable core

Tailpieces and construction keying

Cylindrical lock tailpieces

Throw members shown actual size.

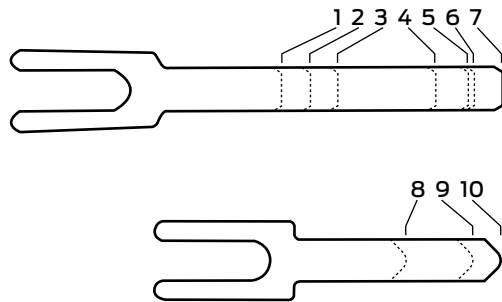

B, RU, T, W and X Series

Ref.	Length	Part number	Application
1	1.40"	022175-000-30	X Series, except X571
2	1.53"	030739-003-30	RU, T381 inside only, 7-pin, B611
3	1.69"	030739-002-30	RU, T381 inside only, 6-pin, B611
4	2.22"	030739-005-30	RU, T571 7-pin
5	2.37"	030739-004-30	RU, T571 6-pin
6	2.41"	030739-001-30	RU, T Series 7-pin except T381 inside and T571
7	2.56"	030739-000-30	RU, T Series 6-pin except T381 inside and T571
8	1.32"	031731-000-30	B Series 6 and 7-pin, except B611
9	1.66"	022175-002-30	X571 7-pin, B611 7-pin
10	1.81"	022175-001-30	X571 6-pin
11	X.XX"	Q330-164	W Series 501, 511, 581, 711 functions
12	X.XX"	Q330-165	W Series 561 function

Y Series

Q001-055

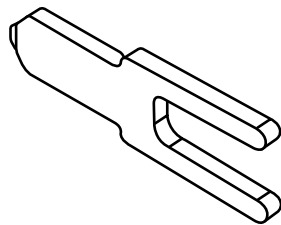

Rim cylinder tailpiece

With 012698 retainer

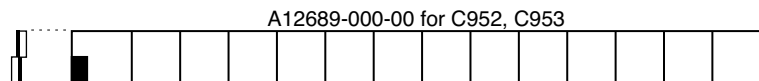

"Disposable construction" core

1408 Disposable small format
Interchangeable construction core

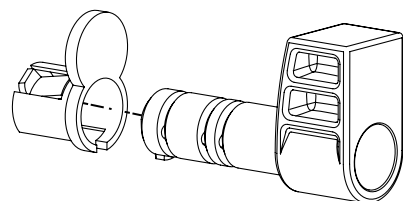

For more options and information on construction keying, please consult page 16 of this catalog.