

90 series Parts List

9706 9710 9713
9715 9728 9762
9763

Parts List

Page No. Rev.
97.7 A

05/10/2004

CHASSIS ASSEMBLY LESS COVER

9700	MANUFACTURED BEFORE 05/10/2004	LHRB RHRB	97-2434
9700	MANUFACTURED AFTER 05/10/2004	LHRB RHRB	68-4557

MANUFACTURED BEFORE 11/11/2002			
ITEM	PART NO.	DESCRIPTION	QTY
1	—	TOP CHASSIS	1
2	68-1155	LATCH RETRACTING LEVER	1
3	97-0065	PIVOT PIN LATCH RETRACTING LEVER	1
4	97-0298	TOP SLIDE	1
5	97-0296	LATCHBOLT	1
6	97-0300	SPRING LATCHBOLT	1
7	97-0294	PIVOT PIN LATCHBOLT	1
8	97-0046	RETAINING PIN TOP SLIDE	2
9	97-0579	SPRING LATCH RETRACTING LEVER	1
10	01-0461	SPIROL PIN LATCH HOLD BACK	1
11	97-0034	TOP ROD * (SPECIFY DOOR SIZE AND CROSS BAR HEIGHT)	1
12	97-0048	RETAINING PIN TOP ROD	1
13	97-0020	ROD GUIDE	1
14	97-0052	SCREW #8-32 x 5/16 *	4
15	97-0018	TOP COVER *	1
—	68-2113	SCREW PACK	1
—	629	TOP STRIKE PACK	1

MANUFACTURED AFTER 11/11/2002			
ITEM	PART NO.	DESCRIPTION	QTY
1	—	TOP CHASSIS	1
2	68-1155	LATCH RETRACTING LEVER	1
3	97-0065	PIVOT PIN LATCH RETRACTING LEVER	1
4	97-0298	TOP SLIDE	1
5	97-0296	LATCHBOLT	1
6	97-0300	SPRING LATCHBOLT	1
7	97-0294	PIVOT PIN LATCHBOLT	1
8	97-0046	RETAINING PIN TOP SLIDE	2
9	97-0579	SPRING LATCH RETRACTING LEVER	1
10	01-0461	SPIROL PIN LATCH HOLD BACK	1
11	68-0003	TOP ROD * (SPECIFY DOOR SIZE AND CROSS BAR HEIGHT)	1
12	01-0002	RETAINING PIN TOP ROD ADJUSTER	1
13	97-0020	ROD GUIDE	1
14	97-0052	SCREW #8-32 x 5/16 *	4
15	97-0018	TOP COVER *	1
16	68-1455	TOP ROD ADJUSTER	1
—	68-2113	SCREW PACK	1
—	629	TOP STRIKE PACK	1

* SPECIFY FINISH

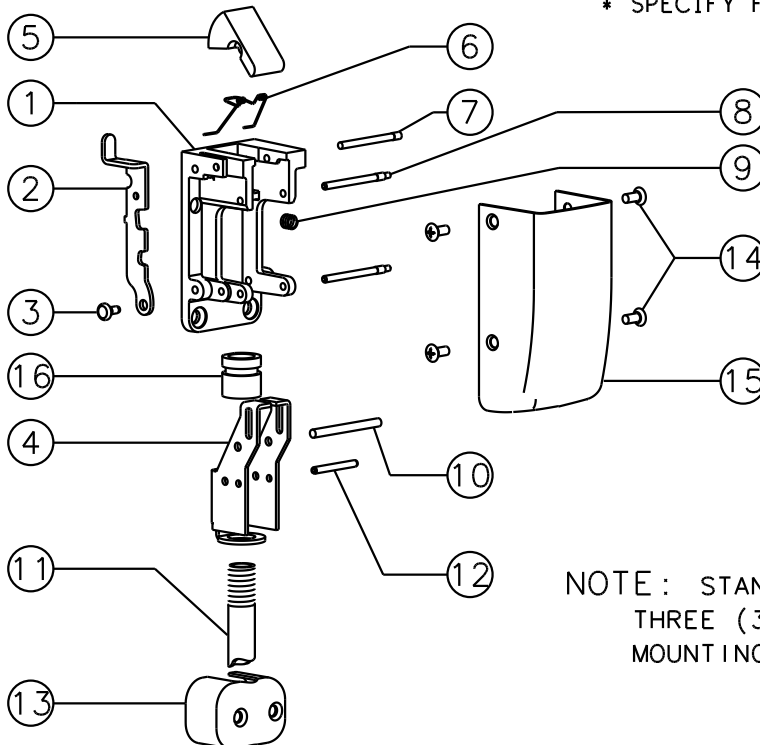

NOTE: STANDARD TOP CHASSIS HAS
THREE (3) SCREW HOLES FOR
MOUNTING TO DOOR.